

**FILTERED WATER STORAGE SUMP**  
 6'-0" x 7'-0" INTL. SIZE  
 10'-0" CLEAR DEPTH  
 0'-9" FREE BOARD  
 0'-6" DEAD STORAGE  
 8'-9" LIQUID DEPTH  
 10,000 LITRES CAPACITY

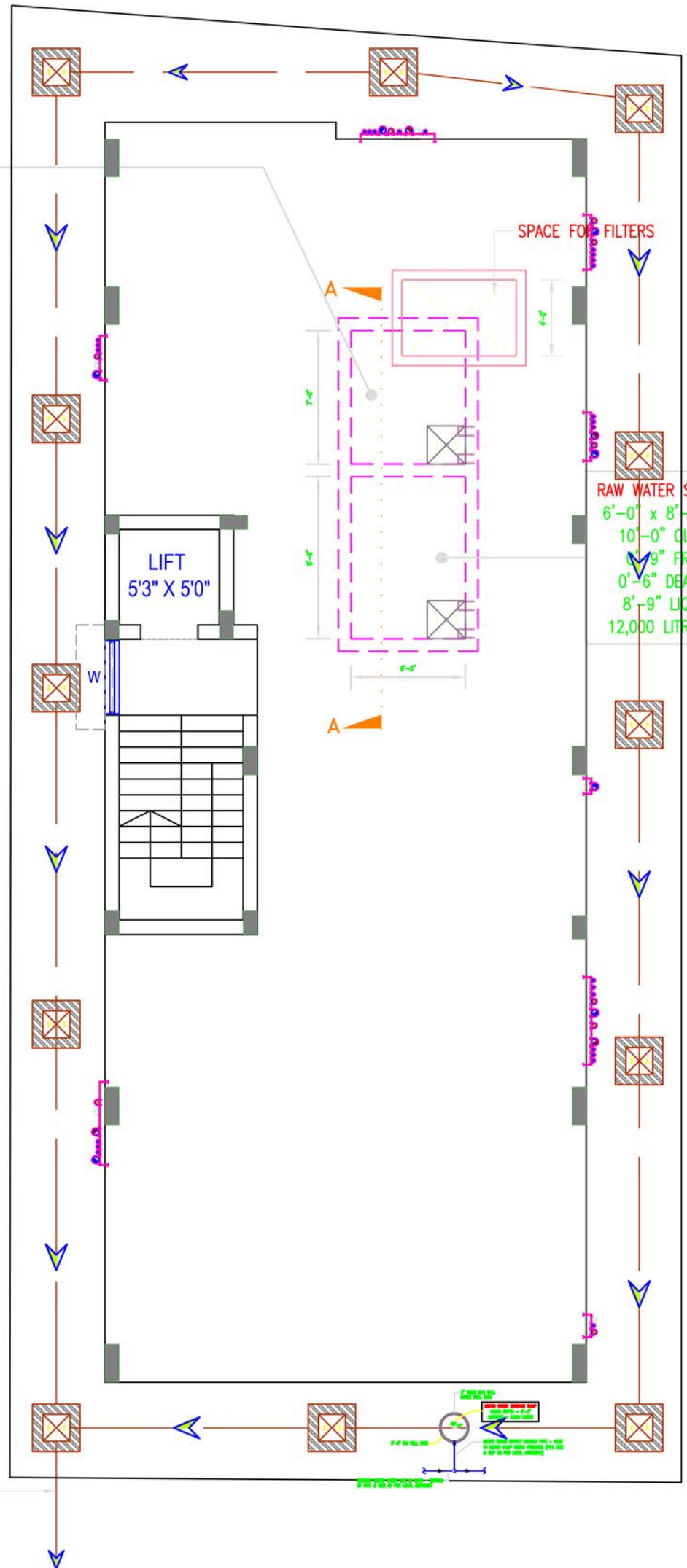
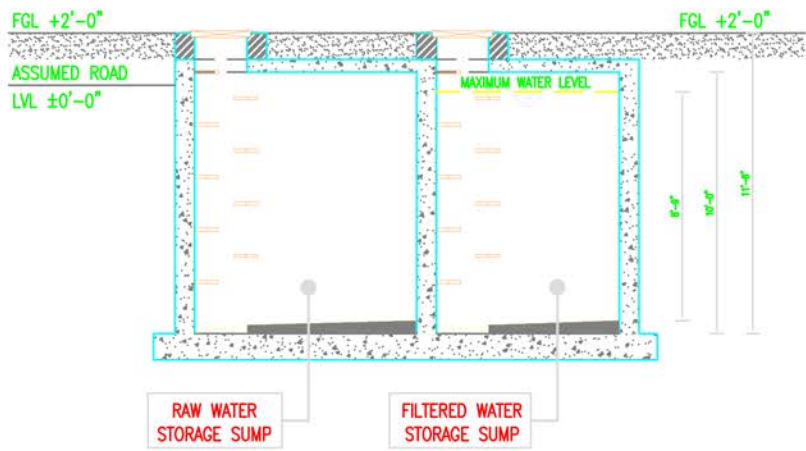

**RAW WATER STORAGE SUMP**  
 6'-0" x 8'-6" INTL. SIZE  
 10'-0" CLEAR DEPTH  
 0'-9" FREE BOARD  
 0'-6" DEAD STORAGE  
 8'-9" LIQUID DEPTH  
 12,000 LITRES CAPACITY

**NOTE:-**

- \* PRIOR TO EXECUTION OF SEWER PIPE WORK, THE CONTRACTOR SHALL CHECK THE INVERT LEVEL OF PROPOSED MANHOLE PROVIDED ON UNDER GROUND DRAINAGE (UGD) SYSTEM IN CONSULTATION WITH THE CONCERNED AND CHECK THE FEASIBILITY OF CONNECTING THE SAME.
- \* IF ANY CHANGE IS REQUIRED IN INVERT LEVEL, THE SAME PLEASE BE BROUGHT TO THE NOTICE OF ARCHITECT / CONSULTANTS FOR TAKING FURTHER DECISION.

NO.	REVISION/ISSUE	DATE	DRAWN	NO.	REVISION/ISSUE	DATE	DRAWN
RO	ISSUED FOR APPROVAL	14.06.23	LOKESH				

ARCHITECT:  
**D DESIGN CONSULTANTS**  
 DEVENDRAN N. M.Tech.  
 ENGINEERS & BUILDERS.  
 #5/31, PILLAIYAR KOIL STREET,  
 MEDAVAKKAM, CHENNAI - 600 100.  
 Email : ddesignconsultant0707@gmail.com.  
 Website : ddesignconsultant.in.  
 Mobile : 93848 90707.

PROJECT NO : 08/2023  
 CHECKED BY : DEVENDRAN  
 DRAWN BY : LOKESH  
 SCALE : A1  
 A3  
 DATE : 14-06-2023

